

OFFICE OF THE BUILDING INSPECTOR

Centerville, Tennessee

APPLICATION FOR BUILDING PERMIT

Application is hereby made for a building permit to erect/alter a structure as described herein or shown in accompanying plans and specifications, which structure is to be located as shown on the accompanying plot plan. The information which follows and the accompanying plans and specifications with the representations therein contained are made a part of this application, in reliance upon which the Building Inspector is requested to issue a building permit.

CHECK ONE: New Construction _____ Alteration _____ Change In Use _____

Address _____ Lot No. _____ Subdivision _____

Located On The _____ Side Of _____

Located In A _____ Zoning District. Proposed Usage _____

Total Cost \$ _____ Families _____ Height In Feet _____ Stories _____

Owner _____ Address _____

Engineer or Architect _____ Address _____

General Contractor or Builder _____

Address _____ Telephone No. _____

Town of Centerville License No. _____ Issued _____

(Insert Date)

If Total Cost Exceeds \$10,000.00:

General Contractor's Tennessee License Number _____

Recorded In Hickman County Court Clerk's Office _____

(Insert Date)

Total Square Feet:

Building _____ Buildings Not Attached _____ Lot _____

Is The Lot On Which This Construction To Be Located Presently A Deed Of Record Within Itself Or Is The Lot A Sub-Division Of Property Which Is A Deed Of Record? _____

(Insert Which)

If A Subdivided Lot, Has The Subdivision Been Approved By The Centerville Regional Planning Commission? _____ Date _____

(Insert Yes Or No)

If A Subdivided Lot, Has The Sub-Division Been Recorded In The Hickman County Register's Office? _____ If Yes. Deed Book _____ Page No. _____

(Insert Yes Or No)

Is This Construction For Speculative Sale By The Bulder Or As A Result Of Competitive Bids? _____ Other Method _____

(Insert Which)

(If Applicable)

Note: Use the back of this Application to show a rough sketch indicating dimensions of the lot, location of Streets and Alleys, shape and dimensions of all existing and proposed buildings, and dimensions from buildings to lot lines; also, information concerning subcontractor to be used. This application is not acceptable unless all required information is furnished.

In making application for a building permit, The applicant states that the information given is to the best of his knowledge, true and accurate. It is understood, and agreed by the applicant that any error, mis-statement or misrepresentation of fact, either with or without intention on his part, such as might, if known, cause a refusal of this application or any alteration or change in plans made without the approval of the building inspector subsequent to the issuance of the building permit, shall constitute sufficient grounds for the revocation of such permit.

Date _____ Signed _____

Applicant

(Do Not Write Below This Line)

BUILDING PERMIT

BUILDING PERMIT NO. _____ {Refused} Reason If Refused _____ {Granted}

REMARKS _____

DATE _____ BY _____

Centerville Building Inspector

LOT PLAN

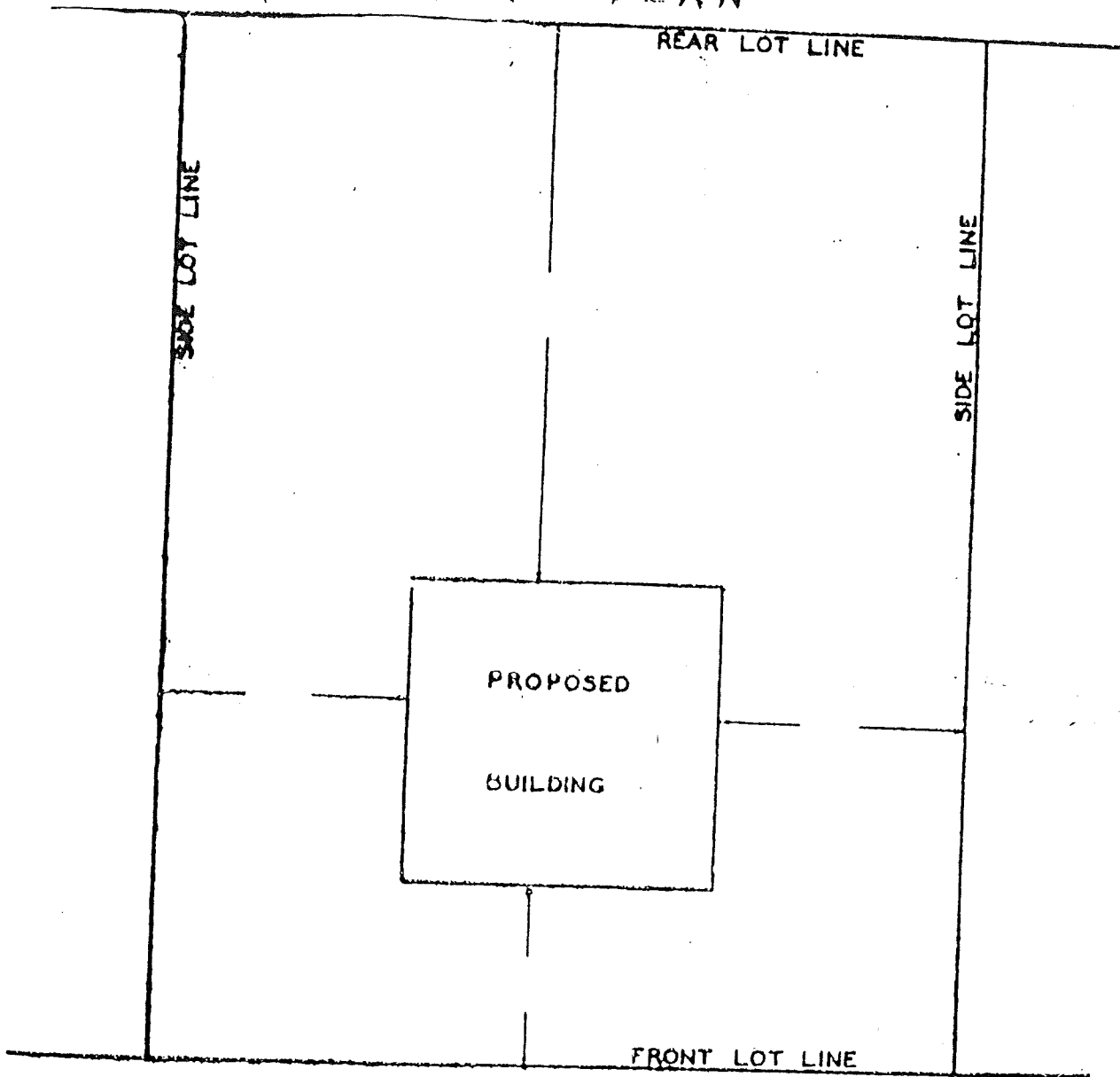

Sub-Contractor Information: (If Done By General Contractor or Bullder, So State)

	Name of Subcontractor	Address	Centerville License Number	Approximate Cost Of Work To Be Done
Excavation	_____	_____	_____	_____
Termite Treatment	_____	_____	_____	_____
Masonry Work	_____	_____	_____	_____
Concrete Work	_____	_____	_____	_____
Carpentry Work	_____	_____	_____	_____
Structural Steel	_____	_____	_____	_____
Roofing Work	_____	_____	_____	_____
Glass & Glazing	_____	_____	_____	_____
Ceramic Tile	_____	_____	_____	_____
Terrazzo Work	_____	_____	_____	_____
Resilient Flooring	_____	_____	_____	_____
Accoustical Ceiling	_____	_____	_____	_____
Plastering	_____	_____	_____	_____
Drywall Installation	_____	_____	_____	_____
Electrical Work	_____	_____	_____	_____
Plumbing Work	_____	_____	_____	_____
Heating-Air Cond'ng ..	_____	_____	_____	_____
Other	_____	_____	_____	_____